

Battery Replacement for Electro Luminescent Clocks

IMPORTANT - READ THIS FIRST!

DO NOT push on the glass face when inserting the clock or thermometer into the holder / mount. Push on the chrome ring or bezel to insert. Make sure clock or thermometer is inserted all the way into holder / mount before riding or loss and / or damage may result. When the clock loses time or stops or the light no longer illuminates the batteries may be due for replacement. The batteries are accessible from the backside of the clock or thermometer. Your Clock will not require you to open it prior to a battery replacement. No other serviceable parts.

SETTING THE TIME & ACTIVATING THE BACK LIGHT (Fig.1): (a) The crown to adjust the time is located on the side of the unit at the Three o'clock position. To set the time, carefully pull the crown out and turn it until the desired time is show. Push crown back in to the normal position to restart the clock.. (b) The button to activate the back light for 5 seconds each push is located above the crown at the Two o'clock position. Push the button once to illuminate the dial for 5 seconds or hold it for constant illumination.

BATTERY REPLACEMENT:

<< CAUTION: DO NOT LIFT THE CLOCK MOVEMENT OUT OF THE CASE >>

NOTE: PREFORM THIS OPERATION OVER A TOWEL OR MAT SO PARTS DON'T GET LOST TO REMOVE YOUR CLOCK FROM THE HOLDER / MOUNT:

Take a sharp object like a pocket knife and put it gently into the departure line between the clock or thermometer and the holder / mount. Then pry the clock or thermometer up using a twisting motion so you can get a fingernail under it and lift it out. Perform this operation over a table with a towel as not to lose or drop the clock or thermometer on the floor and damage it.

(Fig.2) Clocks are manufactured with a screw on / off back cover. You can use a needle nose pliers or similar tool to easily remove and replace the back cover. Place the tools tips in the slots of the case back and unscrew counter-clockwise. Jewelers also have a tool made specifically for this purpose.

(Fig.3) Tools required to change batteries are a fine jeweler type phillips screw driver (for the back light battery only) and pointed tweezers or small needle nose pliers.

(Fig.4) Once screw back has been removed, use tweezers to remove round plastic retaining ring, note it's position for re-installation. If only replacing the watch battery and not the back lighting battery (back light battery is the first visible) please skip to (fig.8).

(Fig.5) The back lighting battery is replaced by removing the very small phillips head screw at the end of the retaining bracket.

(Fig.6) Once the old battery is removed you may replace the battery with the same or equivalent number battery (CR2025) with positive pole (+) facing outward and reinstall the retaining bracket using the small phillips head screw.

(Fig.7) To reach the clock battery use a tweezers or small needle nose pliers to carefully remove the entire lighting assembly containing the large battery from the housing, being very careful not to lift the clock and face assembly out with it. These two parts are located to each other using a series of small molded prongs that may stick together. (you may have to gently pry the light assembly from the clock face assembly)

(Fig.8) Once the lighting assembly has been removed the clock mechanism and back side of the face is visible.

(Fig.9) The battery is retained in position by a tiny metal prong. You may just carefully pry up at the bottom of the battery to remove it. Be sure when replacing the battery to use the same number (SR626SW) or equivalent button cell, with positive pole (+) facing outward. Make sure it is replaced securely in position and under the small metal prong.

REPLACING ALL COMPONENTS AND SEALING THE CLOCK OR THERMOMETER:

After the batteries have been replaced and have checked to make sure the components are functioning properly you may reverse the previous steps to reassemble the unit. The case has a slot on the inside wall of the case at the twelve o'clock position, the white back light assembly has a matching tab that meets it to align the assembly inside the case. Make sure the three white prongs on the clock face that remains in the case is at the top with the center prong lined up with the slot on the inside case wall. When the center prong is in line with the slot you may re-insert the back light assembly and compress the parts together to lock them in place. Then re-insert the white retaining ring shown in (Fig.4) making sure the recessed areas around the inside of the ring line up and provide clearance for the four screws on the back of the back light assembly (one recess is just slightly off and will rest on one of the screws). Press the ring in place and reinstall the back of the case with spanner tool provided or the like. Note: Make sure the black O ring is properly set on the clocks back cover is in position and will form a satisfactory water tight seal and the case backing is not cross threaded.

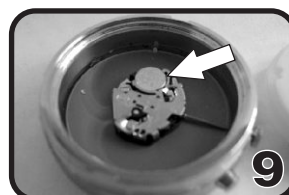
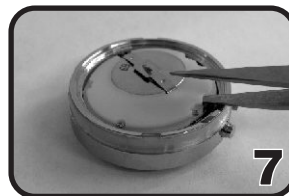
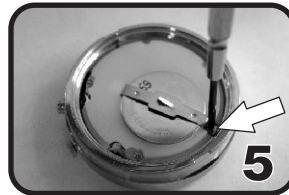
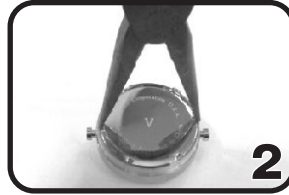
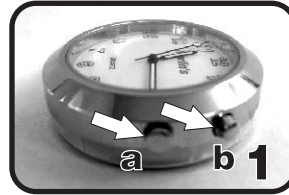

FACTS ABOUT THE COMPRESSION RING USED TO HOLD YOUR CLOCK OR THERMOMETER IN THE HOLDER / MOUNT:

When the clock or thermometer has been installed in the holder / mount for a long time and you remove it from the holder / mount to change the battery or other reason, the rubber compression ring may stay compressed. To avoid a loose fit put a fresh compression ring on the clock or thermometer (a spare should have been supplied with the purchase of your new Marlin's item). Note the compression rings position before removing it, the wide part of the nub molded into the ring should face up and to the out side of the clock or thermometer. To rejuvenate or expand the used compression ring back to it's original size, place it in very hot water for a minute or two, then put the ring in cold water and it will bring it back to shape for the next time you need to switch compression rings.

It is recommended when you take the clock or thermometer out of the holder/mount to use some isopropyl alcohol and clean the inside rim of the holder / mount were the clock or thermometer goes to eliminate any dirt or oils that could reduce the gripping power of the compression ring.

CHROME CARE:

The holder / mount and bezel can be polished and cared for with a quality chrome polish. Your new clock or thermometer is waterproof, shock resistant and the numbers may glow in the dark if so equipped. The face must be exposed to a light source before you ride to charge and activate the glow in the dark feature.

TO RE-INSERT YOUR CLOCK OR THERMOMETER INTO THE HOLDER/MOUNT:

You can moisten a paper towel with Windex or similar product (NO silicon or oil based product), then wipe it on the rubber ring around the clock to help you slide the clock in to the holder. (Allow the Windex or other product to dry completely before riding) Turn the clock in the position you like and push it in place, push inward on the chrome edges or bezel of the unit, making sure that the rubber ring is not stuck on the edge of the holder / mount, (you may use your fingernail or similar object to make sure the rubber ring is in place properly) and there is no gap so that the unit is firmly in place.

When replacing the clock or thermometer in the holder, press on the chrome bezel not the crystal / glass.

ALL RETURNS MUST BE PACKED TO ELIMINATE DAMAGE DAMAGED RETURNS WILL NOT BE ACCEPTED

Enjoy your Marlin's Product
www.marlinlocks.com

Operation & Battery Replacement for LED Equipped Clocks

IMPORTANT - READ THIS FIRST!

DO NOT push on the glass face when inserting the clock into the holder / mount. Push on the chrome ring or bezel to insert. Make sure clock is inserted all the way into holder / mount before riding or loss and / or damage may result. When the clock loses time or stops or the LED clock no longer illuminates the batteries may be due for replacement. The batteries are accessible from the backside of the clock as outlined below.

SETTING THE TIME, DATE & ACTIVATING THE LED FUNCTIONS (Fig.1): (a) The button to activate the LED clock is located above the crown at the two o'clock position. Push the button once to illuminate the time for 3 seconds. You may also hold the button down for continued illumination. (b) The crown to adjust the analog time is located on the side of the unit at the three o'clock position. To set the time, carefully pull the crown out and turn it until the desired time is shown. Push crown back in to the normal position to restart the clock (the LED clock and analog clock operate independently and need to be set separately). (c) The button to activate the LED date function is located below the crown at the four o'clock position. Push the button once to illuminate the date for 3 seconds. You may also hold the button down for continued illumination. (d) The button to set the LED time & date function is located at the eight o'clock position. To Set The Time: Push the (a) button once to illuminate the time, then immediately push the (d) button to put the unit into set mode. Once put into set mode the display will begin to flash and you may use the (a) button to set the hours, including the am/pm dots in the center and use the (c) button to set the minutes. After you set the unit it will return to its regular operating mode on its own.

To Set the Date: Push the (c) button once to illuminate the date, then immediately push the (d) button to put the unit into set mode. Once put into set mode the display will begin to flash and you may use the (a) button to set the month and use the (c) button to set the day. After you set the unit it will return to its regular operating mode on its own.

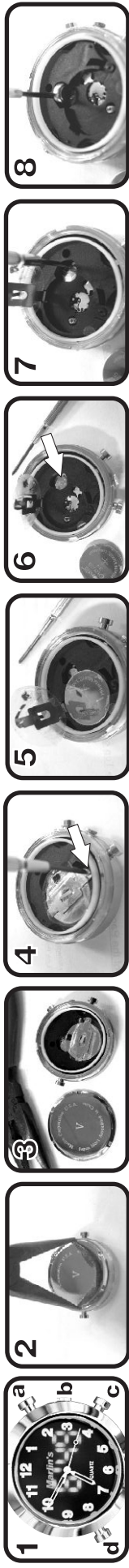

BATTERY REPLACEMENT:

CAUTION: DO NOT LIFT MOLDED COMPONENTS OUT OF CASE

NOTE: PERFORM THIS OPERATION OVER A TOWEL
OR MAT SO SMALL PARTS DON'T GET LOST

TO REMOVE YOUR CLOCK FROM THE HOLDER / MOUNT:

Take a sharp object like a pocket knife and put it gently into the departure line between the clock and the holder / mount. Then pry the clock out using a twisting motion so you can get a fingernail under it and lift it out. Perform this operation carefully over a towel as not to lose or drop the clock on the anything and damage it.

(Fig.2) Clocks are manufactured with a screw on / off back cover. A needle nose pliers or similar tool may be used to easily remove and replace the back cover. Place the tools tips in the slots of the case back and unscrew counter-clockwise. Jewelers also have a tool made specifically for this purpose.

(Fig.3) Clock shown with back cover removed. Tool required to change batteries are a fine jeweler type phillips screw driver.

(Fig.4) Once screw back has been removed, carefully lift the clear protective adhesive decal enough to expose the fine phillips screw, use a fine jeweler type phillips screwdriver to unscrew the retaining plate.

(Fig.5) With the retaining plate lifted the battery for the LED unit is exposed. Make sure to retain the clear adhesive decal in the position it was originally in.

(Fig.6) Once the old battery is removed you may replace the battery with the same or equivalent number battery (CR2025) with positive pole (+) facing outward. With the LED battery removed the battery for the analog clock is now unobstructed and fully visible.

(Fig.7) To replace the analog clock battery use the small screwdriver and push down firmly on the battery at the far side from the LED battery near the small hook shaped tab as the picture shows.

(Fig.8) The battery should pop out using sufficient force down on the screwdriver. Be sure when replacing the battery to use the same number (SR626SW) or equivalent button cell, with positive pole (+) facing outward. Make sure it is replaced securely in position and under the small metal prong. It must be replaced in the reverse order inserting the battery under the hook shaped prong side first.

REPLACING ALL COMPONENTS AND SEALING THE CLOCK:

After the batteries have been replaced reverse the previous steps to reassemble the unit.

FACTS ABOUT THE COMPRESSION RING USED TO HOLD YOUR CLOCK IN THE HOLDER / MOUNT:

When the clock has been installed in the holder / mount for a long time and you remove it from the holder / mount to change the battery or other reason, the rubber compression ring may stay compressed. To avoid a loose fit put a fresh compression ring on the clock (a spare should have been supplied with the purchase of your new Marlin's item). Note the compression rings position before removing it, the wide part of the nub molded into the ring should face up and to the out side of the clock.

To rejuvenate or expand the used compression ring back to it's original size, place it in very hot water for a minute or two, then put the ring in cold water and it will bring it back to shape for the next time you need to switch compression rings. It is recommended when you take the clock out of the holder/mount to use some isopropyl alcohol and clean the inside rim of the holder /

mount were the clock goes to eliminate any dirt or oils that could reduce the gripping power of the compression ring.

CHROME CARE:

The holder / mount and bezel can be polished and cared for with a quality chrome polish.

Your new clock is waterproof, shock resistant and the numbers may glow in the dark if so equipped. The face must be exposed to a light source before you ride to charge and activate the glow in the dark feature.

TO RE-INSERT YOUR CLOCK OR THERMOMETER INTO THE HOLDER/MOUNT:

You can moisten a paper towel with Windex or similar product, then wipe it on the rubber ring around the clock to help you slide the clock in to the holder. (Allow the Windex or other product to dry completely before riding.) Turn the clock in the position you like and push it in place, push inward on the chrome edges or bezel of the unit, making sure that the rubber ring is not stuck on the edge of the holder / mount, (you may use your fingernail or similar object to make sure the rubber ring is in place properly) and there is no gap so that the unit is firmly in place.

When replacing the clock in the holder, press on the chrome bezel not the crystal / glass.

Enjoy your Marlin's Product
for technical help contact

www.marlinsclocks.com

248-683-1536